

JAPANESE

ENGLISH

FRANÇAIS

TD725SWMK2 TD520SW SUBWOOFER

Instruction Manual **ENGLISH**

Thank you for purchasing this product.

Please read this instruction manual carefully and use the product correctly.

Before using the product, please read the "Important Safety Instructions" section.

Please keep this instruction manual together with the original product purchase receipt in a place where it can be referred to when necessary.

Contents

Checking the main unit and accessories	23	Basic usage (listening to audio) ...	36
Important Safety Instructions.....	24	Mute	36
Important items for safety	27	Automatically turning the power on and off (auto power)	37
Part names and functions.....	29	Adjusting the audio	37
Rear panel	29	Adjusting the volume	37
Front panel	30	Adjusting the LPF	38
Remote control	30	Switching the phase polarity	38
Inserting batteries into the remote control	32	Switching bass emphasis (BASS)	38
Setting up the subwoofer	33	Care and cleaning.....	39
Attaching the feet	33	When a problem occurs.....	39
Setup location.....	33	Specifications	40
Connecting the subwoofer	34	Warranty and customer service ..	41
Typical connection.....	34		
Connection with the speaker terminals...	35		

Audio etiquette

- Your enjoyable music may be bothersome depending on the location. Please enjoy your music at an appropriate volume so that it does not bother your neighbours.
- In particular, even music at a low volume can easily travel through your surroundings at night.
Please be considerate of your neighbours and help create a comfortable living environment.

Checking the main unit and accessories

- Subwoofer x1

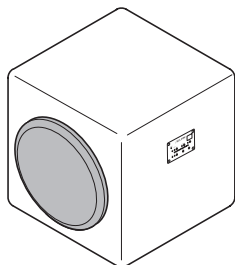

- Power cable x1 (P.34, 35)



- Remote control x1

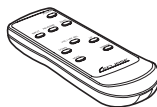

- Battery for remote control (size AAA) x2 (P.32)



- Foot x4 (P.33)



- Instruction manual x1

Important Safety Instructions



CAUTION

RISK OF ELECTRIC SHOCK
DO NOT OPEN



CAUTION : TO REDUCE THE RISK OF ELECTRIC SHOCK, DO NOT REMOVE COVER (OR BACK). NO USER-SERVICEABLE PARTS INSIDE. REFER SERVICING TO QUALIFIED SERVICE PERSONNEL.

WARNING

TO REDUCE THE RISK OF FIRE OR ELECTRIC SHOCK, DO NOT EXPOSE THIS APPLIANCE TO RAIN OR MOISTURE.

• Explanation of Graphical Symbols

The lightning flash with arrowhead symbol, within an equilateral triangle, is intended to alert you to the presence of uninsulated dangerous within the product's enclosure that may be of sufficient magnitude to constitute a risk of electric shock.



The exclamation point within an equilateral triangle is intended to alert you to the presence of important operating and maintenance (servicing) instructions in the literature accompanying the appliance.



CAUTION

TO PREVENT ELECTRIC SHOCK, MATCH WIDE BLADE OF PLUG TO WIDE SLOT AND FULLY INSERT.



WARNING

When there is a problem or malfunction...

- **When one of the following problems occurs, immediately stop using the product, turn off the power, and unplug the power plug from the power outlet.**
 - The product produces an unusual noise or smell
 - The product produces smoke
 - The product is falls or is damaged

If you continue using the product when there is a problem, there is a risk of fire or electric shock.

- **Do not repair, disassemble, or modify the product yourself.**

There is a risk of fire, electric shock, or injury.

For repair, inspection, and adjustment, contact customer service. (P.41)

During use...

- **Do not place vases, flower pots, cups, makeup, chemicals, or other containers that contain liquids on or near the product.**

There is a risk of fire or electric shock due to leaks and foreign substances.



WARNING

Power plug and cable...

- **Do not use the product with a power supply voltage outside that displayed on the main unit.**
There is a risk of fire, electric shock, or malfunction.
- **Always use the included power cable.**
There is a risk of fire or accidents.
- **Do not overload the power outlet by plugging in many devices.**
There is a risk of fire due to the heat generated.
- **Do not damage the power cable in the following ways.**
 - **Scratching the cable - Forcibly bending the cable - Twisting the cable**
 - **Working on the cable - Heating the cable - Pulling the cable**
 - **Placing heavy objects on the cable**There is a risk of fire or electric shock due to damage.
If the power cable is damaged such as when the core is exposed or the cable is broken, please replace it.
- **When there is a risk of lightning, unplug the power plug from the power outlet and do not touch the plug.**
There is a risk of fire, electric shock, or malfunction.



CAUTION

During setup or when moving the product...

- **Do not place the product in the following kinds of locations.**
 - **Rickety platforms, inclined and unstable locations, and elevated locations**
There is a risk of falls, malfunction, or injury.
 - **Locations exposed to oily smoke or steam such as kitchen countertops and near humidifiers**
 - **Locations exposed to direct sunlight for long periods of time and near heaters or open flames**
There is a risk of fire, deformation, discoloration, accidents, or malfunction.
 - **Locations directly exposed to cold air**
 - **Extremely cold locations**
There is a risk of electrical leakage or burnout, accidents, or malfunction due to condensation.
- **Be aware of the following items when moving the product.**
 - **This product is heavy. Always open the product packaging and carry the product with two or more people.**
There is a risk of injury.
 - **Turn off the power to the connected devices and unplug the power cable, connection cables, and speaker cables.**
If the product is moved with the cables connected to it, there is a risk of fire, or electric shock due to damaging the cables.

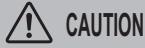

CAUTION

During setup or when moving the product... (Continued)

- **First turn off the power to all devices to connect to the product before making the connections.**
- **Connect each device according to its instruction manual.**
If you connect devices with the power turned on, there is a risk that product may suddenly produce a loud noise and malfunction.

Power plug and cable...

- **Do not use an unstable or loose power outlet.**
There is a risk of fire or electric shock due to the heat generated.
Ask an electrician to replace the power outlet.
- **Do not plug or unplug the power plug with wet hands.**
- **Do not touch the power plug's pins.**
There is a risk of electric shock.
- **Plug the power plug all the way into the power outlet.**
There is a risk of fire due to the heat generated or from accumulated dust.
- **Do not place the power cable near heaters. Do not use the power plug and cable when they are hot.**
The cable jacket will melt causing a risk of fire or electric shock.
- **Regularly remove any accumulated dust on the power plug pins.**
There is a risk of fire or electric shock.
Unplug the power plug and wipe it with a dry cloth.

During use...

- **Do not climb on the product or use it as a step or a seat.**
There is a risk of injury due to the product falling over or being damaged. Households with small children should be particularly careful.
- **Do not take the following actions with the remote control.**
- **Dropping the remote control** - **Hitting the remote control** - **Getting the remote control wet** - **Placing the remote control in humid or dusty locations**
These actions will cause the remote control to break, malfunction, or increase the consumption of the batteries.
- **Before turning on the power, set the volume of the amplifier and subwoofer to the minimum level.**
A loud noise may suddenly occur causing the risk of hearing loss or damage to the product.
- **When the product produces unusual sounds during playback at high volumes, lower the volume.**
If the product is used in this state or the product is used for a long period of time when the sound is distorted, the speaker will generate heat causing the risk of fire.



CAUTION

During care and cleaning...

- **Turn off the power and unplug the power plug from the power outlet.**
There is a risk of electric shock or injury.

When not using the product for a long period of time...

- **Turn off the power and unplug the power plug from the power outlet.**
There is a risk of fire.

■ Important items for safety

- 1) Read these instructions.
- 2) Keep these instructions.
- 3) Heed all warnings.
- 4) Follow all instructions.
- 5) Do not use this apparatus near water.
- 6) Clean only with dry cloth.
- 7) Do not block any ventilation openings. Install in accordance with the manufacturer's instructions.
- 8) Do not install near any heat sources such as radiators, heat registers, stoves, or other apparatus (including amplifiers) that produce heat.
- 9) Do not defeat the safety purpose of the polarized or grounding-type plug. A polarized plug has two blades with one wider than the other. A grounding type plug has two blades and a third grounding prong. The wide blade or the third prong are provided for your safety. If the provided plug does not fit into your outlet, consult an electrician for replacement of the obsolete outlet.
- 10) Protect the power cord from being walked on or pinched particularly at plugs, convenience receptacles, and the point where they exit from the apparatus.
- 11) Only use attachments/accessories specified by the manufacturer.
- 12)  Use only with the cart, stand, tripod, bracket, or table specified by the manufacturer, or sold with the apparatus. When a cart is used, use caution when moving the cart/apparatus combination to avoid injury from tip-over.
- 13) Unplug this apparatus during lightning storms or when unused for long periods of time.
- 14) Refer all servicing to qualified service personnel. Servicing is required when the apparatus has been damaged in any way, such as power-supply cord or plug is damaged, liquid has been spilled or objects have fallen into the apparatus, the apparatus has been exposed to rain or moisture, does not operate normally, or has been dropped.

<For the customers in European union>

The batteries, accumulators, or equipment incorporating batteries or accumulators which are labeled with crossed-out wheeled bin may not be disposed of with household waste.

This mark is based on European Directive 2006/66/EC for the batteries and accumulators. To dispose of waste batteries, accumulators or equipment incorporating them, please take them to the designated collection facilities.

Waste batteries and accumulators have the potential effect on the environment and human health as a result of the presence of hazardous substances, particularly heavy metals such as cadmium, lead, or mercury, the chemical symbol for an element of which is indicated beneath crossed-out wheeled bin.

You can contribute to eliminate this effect by your cooperation.

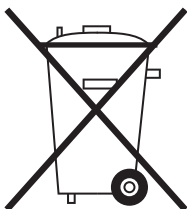

In accordance with the European Directive 2002/96/EC (for Waste Electric and Electronic Equipment=WEEE), this product, which is labeled with crossed-out wheeled bin, may not be disposed of with household waste in member states of the EU.

WEEE : Waste Electrical and Electronic Equipment

When disposing of this product in an EU member state, dispose properly in accordance with the laws of that state, for example by returning it to the distributor. WEEE has the potential effects on the environment and human health as a result of the presence of hazardous substances. You can contribute to eliminate these effects and to enhance reuse/recycle/ other forms of recovery by your cooperation.



Part names and functions

■ Rear panel

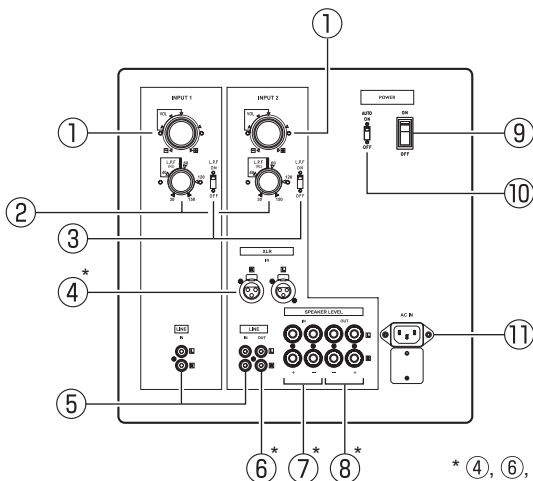

* ④, ⑥, ⑦, and ⑧ are only for INPUT 2

- ① **Volume control (P.37)**
Adjusts the volume.
- ② **L.P.F control (P.38)**
Adjusts (cuts) the high-pass frequency.
Adjustment range: 30 Hz to 150 Hz
- ③ **L.P.F selector switch (P.38)**
Turns the LPF on and off.
- ④ **XLR input terminal**
Connect this terminal if the subwoofer output or line output on your AV amplifier is an XLR connector.
* TD725SWMK2 only
- ⑤ **LINE input terminals (P.34)**
Connect these terminals to the subwoofer output or line output on your AV amplifier.
- ⑥ **LINE output terminals**
Converts the signal input to the XLR input terminal, LINE input terminals, or speaker input terminals to line level and outputs it. (This is not linked to the subwoofer's volume control on this product.)

- ⑦ **Speaker input terminals (P.35)**
Connect these terminals to the speaker output on your AV amplifier if it does not have a subwoofer output.
- ⑧ **Speaker output terminals (P.35)**
Outputs the signal input to the speaker input terminals without modifications.
- ⑨ **POWER switch (P.36)**
Turns the power on and off.
- ⑩ **AUTO POWER switch (P.37)**
Turns auto power on and off.

Advice

The auto power function may not work when the speaker input terminal is connected.

- ⑪ **AC IN terminal (P.34, 35)**
Connect to a household AC power outlet with the included power cable.

■ Front panel

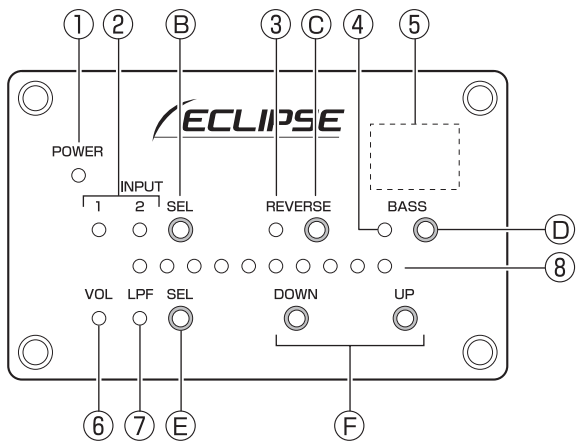

■ Remote control

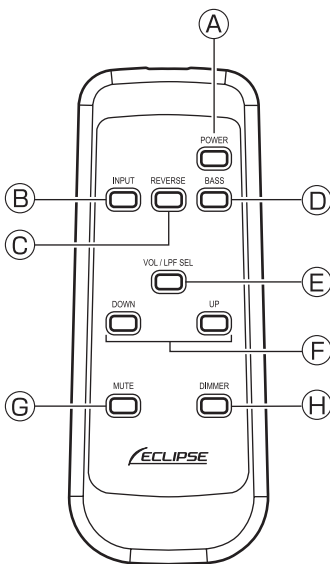

Indicator

- ① **POWER indicator (P.36)**
Lit in blue when the power is on and in red when in the standby status.
- ② **INPUT indicator (P.36)**
The indicator for the selected input turns on.
- ③ **REVERSE indicator (P.38)**
Turned off when set to the positive phase and turned on when set to the negative phase.
- ④ **BASS indicator (P.38)**
Turned on during bass emphasis and turned off when bass emphasis is off.
- ⑤ **Remote control photoreceptor (P.33)**
Receives signals from the remote control.
- ⑥ **VOL indicator (P.37)**
When turned on, you can adjust the volume with the UP/DOWN buttons.
- ⑦ **LPF indicator (P.38)**
When turned on, you can adjust the LPF with the UP/DOWN buttons.
- ⑧ **VOL/LPF level indicator (P.36)**
Shows the volume or the LPF.

Button

- Ⓐ **POWER button (P.36)**
Switches between power on and the standby status.
- Ⓑ **INPUT button (P.36)**
Switches between INPUT 1 and INPUT 2.
- Ⓒ **REVERSE button (P.38)**
Switches between the positive and negative phase.
- Ⓓ **BASS button (P.38)**
Turns bass emphasis on and off.
- Ⓔ **VOL/LPF SEL button (P.38)**
Switches between adjusting the volume and the LPF.
- Ⓕ **DOWN button (P.38)**
UP button (P.37)
Adjusts the volume or the LPF.
- Ⓖ **MUTE button (P.36)**
Mutes the sound.
- Ⓗ **DIMMER button**
Adjusts the brightness of the indicators. The brightness changes with each press of the button in the following order: bright → normal → dark → off. (When set to off, only the POWER indicator remains on.)

Inserting batteries into the remote control

- 1** Open the rear cover on the remote control by pressing it and pulling it in the direction of the arrow.

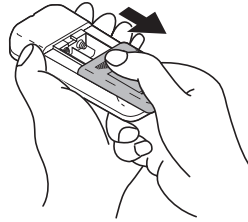

- 2** Insert two batteries into the battery compartment as indicated.

Use size AAA batteries.

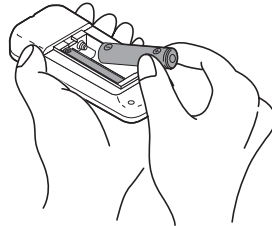

- 3** Push the rear cover in the direction of the arrow to close the battery case.

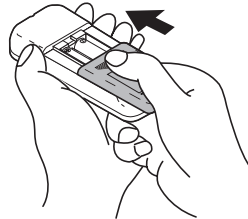

The service life of the included batteries is approximately one year. When the remote control no longer works well, replace the batteries with new batteries.

CAUTION

- Do not mistake the polarity of the batteries (positive (+) and negative (-) directions).
- Do not mix new batteries and old batteries.
- Do not mix different types of batteries.
- If a battery has leaked, wipe up the fluid in the battery compartment and replace the batteries with new batteries.

Setting up the subwoofer

■ Attaching the feet

If the subwoofer will be placed on solid flooring, attach the feet to its bottom.

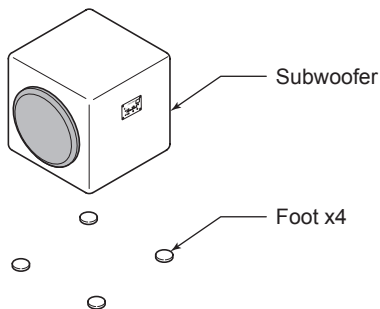

Advice

When performing this work, lay out a soft towel or cloth so you do not scratch the subwoofer or floor.

■ Setup location

- Position the front panel in the direction of viewing and listening.
- If you position the driver unit parallel to the room, sound cancellation may occur due to the sound being reflected from the walls. We recommend placing the subwoofer at an angle to parallel surfaces.

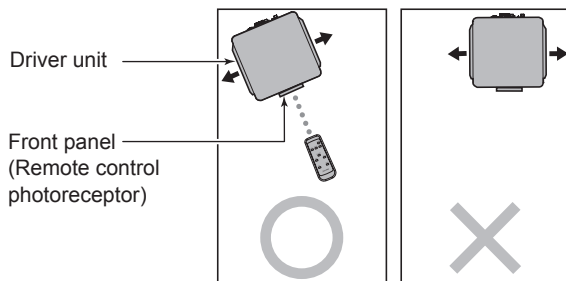

Advice

Place the subwoofer so that the remote control photoreceptor is not exposed to strong light, such as direct sunlight. (Remote control operations may not be received or there may be malfunctions.)

Connecting the subwoofer

■ Typical connection (when the AV amplifier has a subwoofer output)

5.1 channel system connection example

Player + AV amplifier + TD712zMK2 + TD725SWMK2

(The TD510MK2 + TD520SW can be connected in the same manner.)

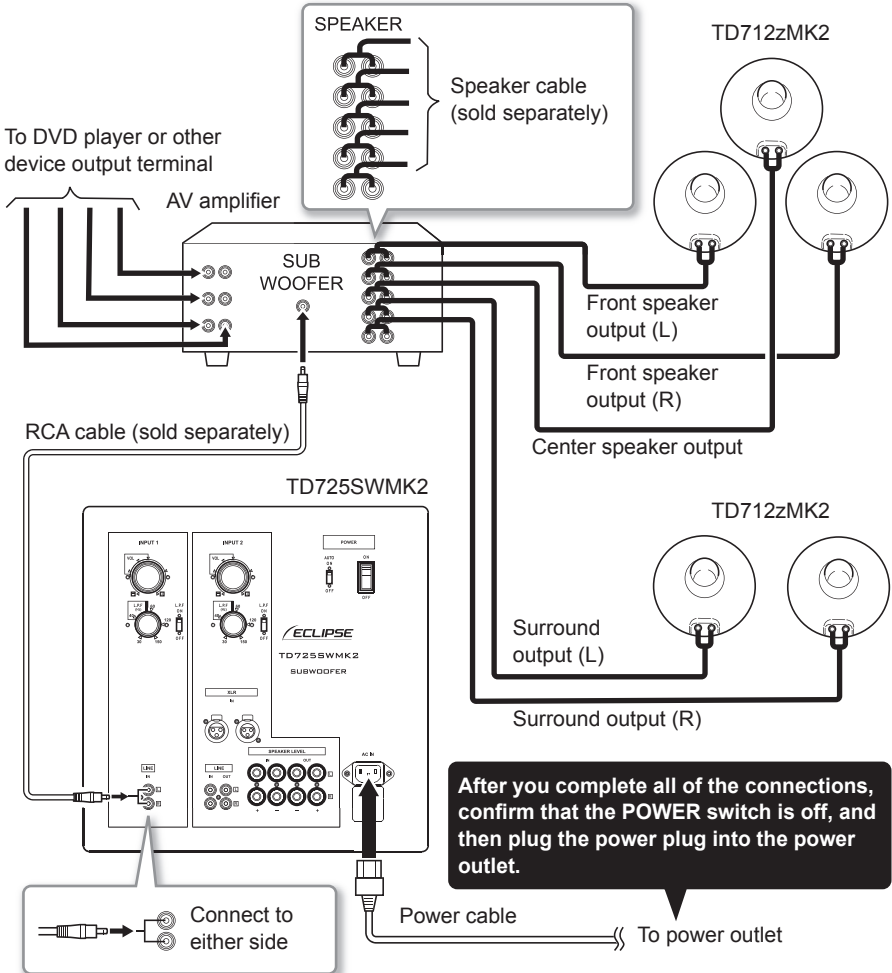

If your AV amplifier has only one subwoofer output channel, connect the cable to either line-in terminal, or use a splitter cable (sold separately) and connect the cables to both line-in terminals.

* Cables that are sold separately can be purchased from your local dealer.

Advice

The volume (P.37) and LPF (P.38) can be independently adjusted by using the inputs.
 Connection example: Connect a surround system subwoofer output to INPUT 1
 Connect a stereo source L/R outputs to INPUT 2

■ Connection with the speaker terminals (when the AV amplifier has no subwoofer output)

2.1 channel system connection example

Player + AV amplifier + TD712zMK2 + TD725SWMK2

(The TD510MK2 + TD520SW can be connected in the same manner.)

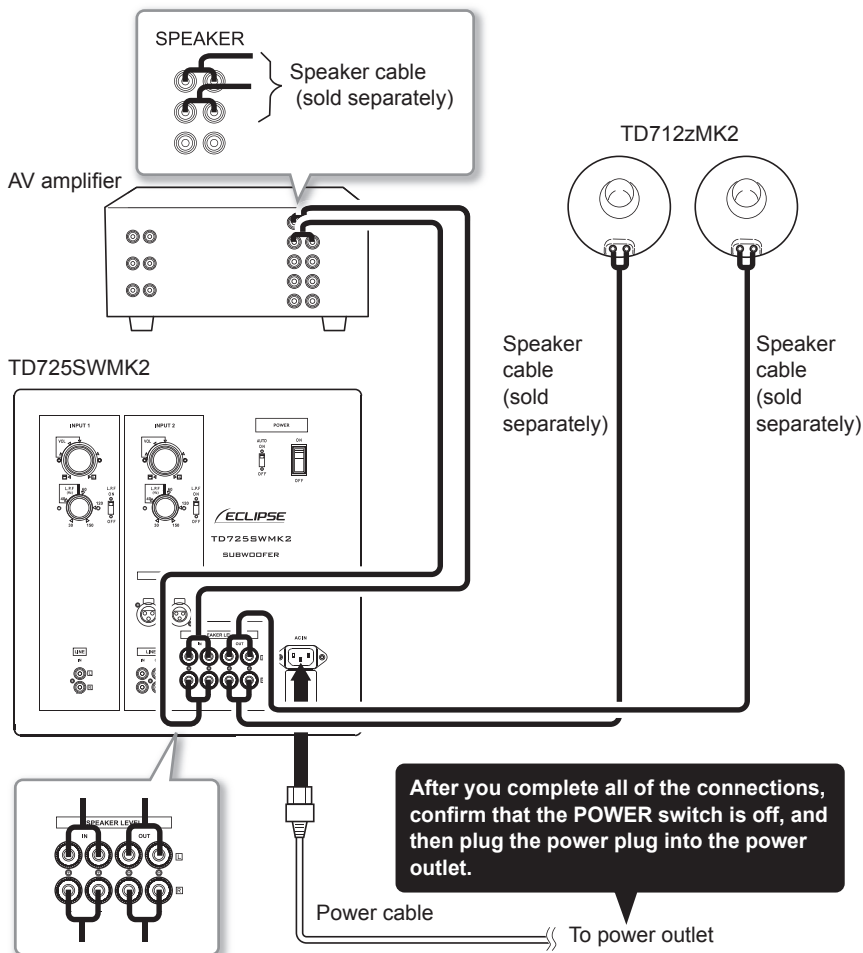

* Cables that are sold separately can be purchased from your local dealer.

Basic usage (listening to audio)

1 Turn on the power.

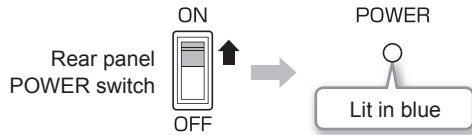

2 Select the desired input.

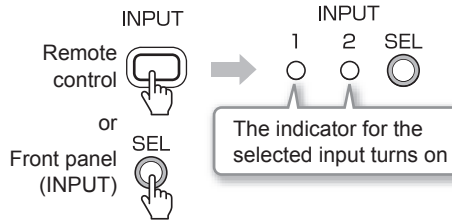

3 Play the audio source.

To adjust the audio quality, see "Adjusting the audio" (P.37).

■ Mute

You can temporarily turn off the subwoofer audio.

To return to normal, press the MUTE button once again.

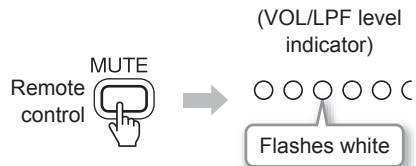

4 When you are finished listening, set the power to the standby status.



■ **Automatically turning the power on and off (auto power)**

The subwoofer is capable of automatically turning the power on and off by detecting the presence of the input signal.

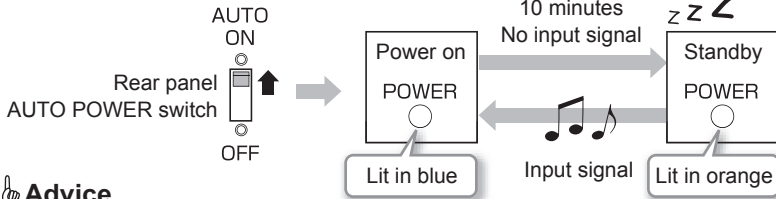

Advice

- The auto power function may not work when the speaker input terminal is connected. In this situation, use the remote control to switch to standby.
- When using the subwoofer at extremely low volumes, turn the AUTO POWER switch off to prevent malfunction.

Adjusting the audio

■ **Adjusting the volume**

- 1** Set the volume to "-" (minimum).

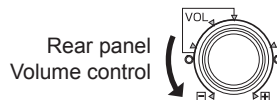

- 2** Play the audio source.

Set the amplifier volume to the level you normally listen at.

- 3** Increase the subwoofer's volume and balance the volume with the speakers being used.

You can also adjust the volume with the volume control on the rear panel.

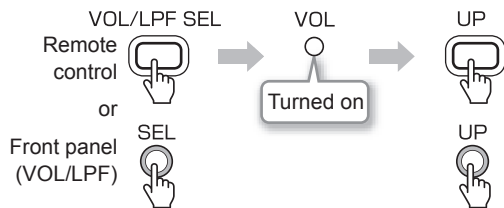

■ Adjusting the LPF

This function cuts off audio with a frequency higher than the set frequency.

For CDs and similar materials, we recommend adjusting the LPF with the subwoofer, and for surround audio sources such as Blu-rays, we recommend turning the L.P.F selector switch off and adjusting the LPF on the player or AV amplifier.

1 Turn on the L.P.F selector switch.

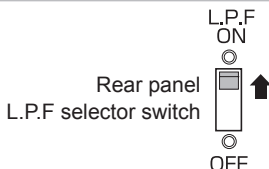

2 Set the LPF.

You can also adjust the volume with the L.P.F control on the rear panel.

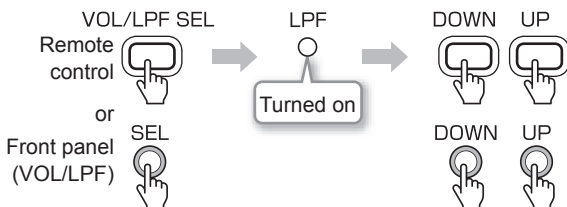

If the mid-low range is insufficient, set the frequency higher.
(Range: 30 Hz to 150 Hz)

■ Switching the phase polarity

1 Switch the polarity to select the method where the bass sounds the richest.

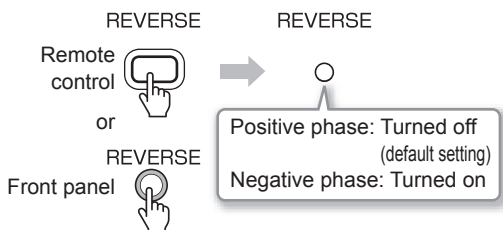

■ Switching bass emphasis (BASS)

You can turn bass emphasis on and off.

To return to normal, press the BASS button once again.

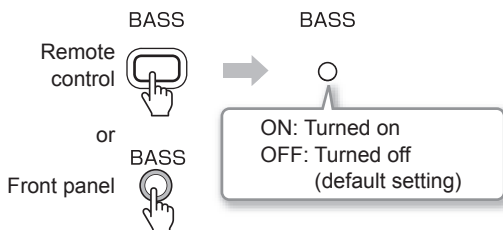

Care and cleaning

- If the dirt is particularly bad, gently wipe it off with a soft cloth moistened with a diluted neutral detergent, and then finish with a dry cloth.
- Do not use paint thinner, benzine, or other solvents.
(This may damage the subwoofer cabinet finish.)



CAUTION

- **Before cleaning the subwoofer, always turn off the power and unplug the power plug from the power outlet.**
There is a risk of electric shock or injury.

When a problem occurs

When a problem occurs with the operation of the subwoofer, turn off the POWER switch on the rear panel, and then turn it back on.

Causes of problems

- The subwoofer has been affected by an excessive shock, static electricity, or a power supply voltage problem due to lightning.
- The subwoofer was mistakenly operated.

→If the problem continues to occur, please contact customer service. (P.41)

Specifications

	TD725SWMK2	TD520SW
Rated output	500 W (when THD: 1%)	250 W (when THD: 1%)
Total harmonic distortion	0.05% (at 50 Hz, 1/2 rated output)	
Signal-to-noise ratio	95 dB or higher	
Playback frequency response	20 Hz to 150 Hz (-10 dB) (BASS MODE, LPF 150 Hz)	25 Hz to 150 Hz (-10 dB) (BASS MODE, LPF 150 Hz)
Input	LINE (stereo), 2 inputs Speaker Level, 1 input XLR (stereo), 1 input * Pin number 2 is HOT.	LINE (stereo), 2 inputs Speaker Level, 1 input
Input sensitivity	LINE 50 mVrms (100 Hz)	
Input impedance	During LINE and XLR input 10 k Ω or higher During Speaker Level input 3 k Ω	During LINE input 10 k Ω or higher During Speaker Level input 3 k Ω
Output	LINE (stereo), 1 output and Speaker Level, 1 output	
Power consumption	110 W	65 W
Standby power	0.5 W or less	
Drive unit dimensions	25 cm \times 2	20 cm \times 2
External dimensions (mm)	W545 \times H500 \times D524 (Including protrusions)	W459 \times H420 \times D444 (Including protrusions)
Weight (1unit)	Approx. 51 kg	Approx. 37 kg

* The specifications and appearance may change without prior notification due to product improvements.

Warranty and customer service

- Customer service for enquiries related to usage, care, and repair of the product

For UK: Fujitsu Ten (Europe) GmbH, UK Office
**For other countries: Please contact the retailer/
 distributor of your country.**

Tel : +44 (0)20 7328 4499
 Fax : +44 (0)20 7624 6384
 mailto : info@eclipse-td.co.uk

■ Warranty

Warranty period: One year (two years for EU Countries) from the date of purchase. Even during the warranty period, you may be charged for services. Please be consulted about the details.

■ Minimum retention period of performance parts for repair

Performance parts for repair are parts required to maintain the performance of the product.

The minimum retention period of performance parts for repair for this product is eight years from the end of production.

■ Repairs during the warranty period

The product will be repaired in accordance with the warranty provisions.

■ Repairs after the warranty period elapses

If the product can be made usable through repairs, it will be repaired for a fee at your request.

Safety check



Check your audio equipment for a long service life!

Have you noticed any of these symptoms?

- The power cable or plug is unusually hot.
- There is a burning smell.
- There is a deep cut in the power cable or it has deformed.
- Other problems or a malfunction.

Stop using the product

- To prevent the product from malfunctioning or causing an accident, turn the POWER switch off, unplug the power plug from the power outlet, and request an inspection of the product.
 For the likely charge to inspect and repair the product, contact as above.